

This tutorial shows how to replace the Front Foil on your XE-1.

## 1. REMOVE FRONT FOIL

### TOOLS REQUIRED

ID	Description	Task
	4 mm Hex Key (Allen Key)	Loosen M6 Countersunk Screws

1.1 Loosen the two countersunk M6 Foil Screws by rotating anti-clockwise. [Tools: 4mm Hex Key].

**INFORMATION:** It is normal for the screws to feel tight and offer some resistance initially as medium strength thread locker (Loctite) is used on the thread of the screws. Ensure that the hex drive or allen key is not damaged and fits the screw socket perfectly.



1.2 While holding the Front Tiller Assembly and Front Foil, remove the screws that are to be replaced from the

assembly.

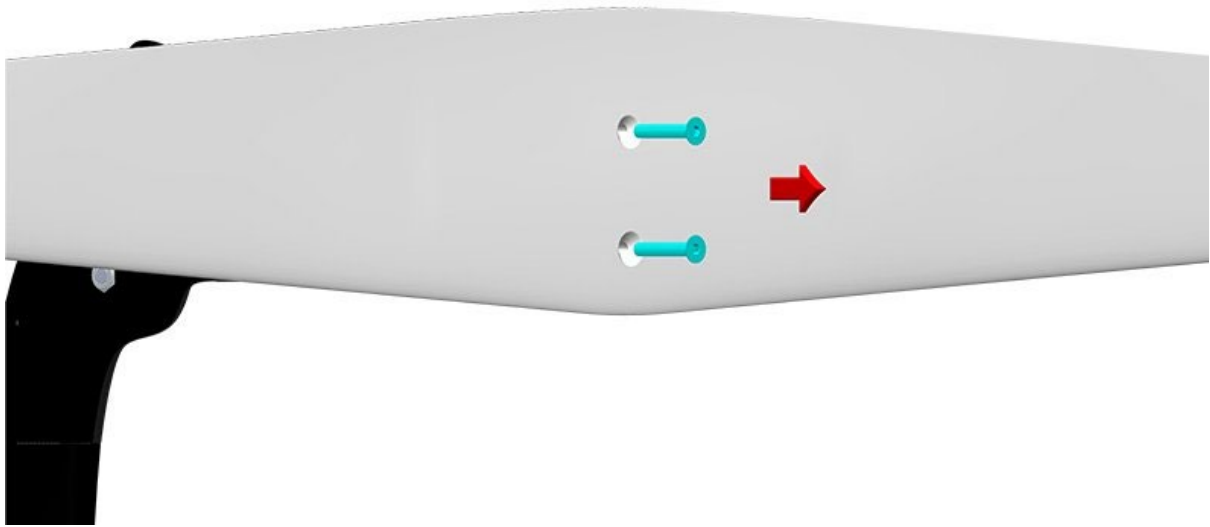

**IF YOUR XE-1 FRONT TILLER ASSEMBLY IS NEW AND HAS NOT BEEN USED, PROCEED TO STEP 2.3**

1.3 Remove the Front Foil from the Front Tiller Assembly.

**INFORMATION:** Note that the front of the foil (leading edge) has a bigger radius and is more rounded than the trailing edge of the foil which has a thin edge.

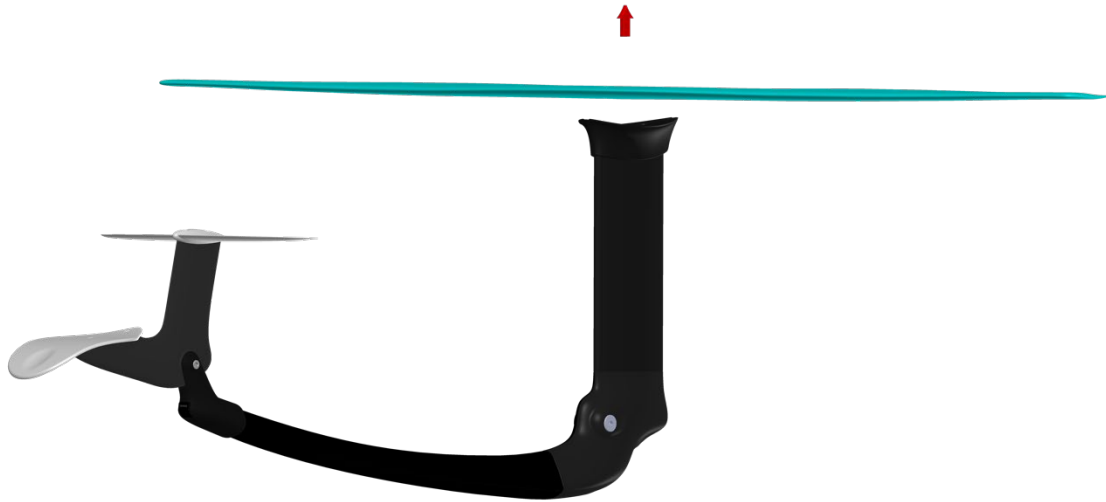

1.4 Remove the Front Foil Shoe from the Front Tiller Assembly and clean off any sand that may have collected between the Front Foil Shoe and Front Tiller Strut (aluminum extrusion).

**INFORMATION:** Note that, similar to the Front Foil, the front of the Front Foil Shoe has a bigger radius and is more rounded than the trailing edge of the foil which has a sharp edge.



1.5 Inspect the M6 x 1 (standard) screw threads.

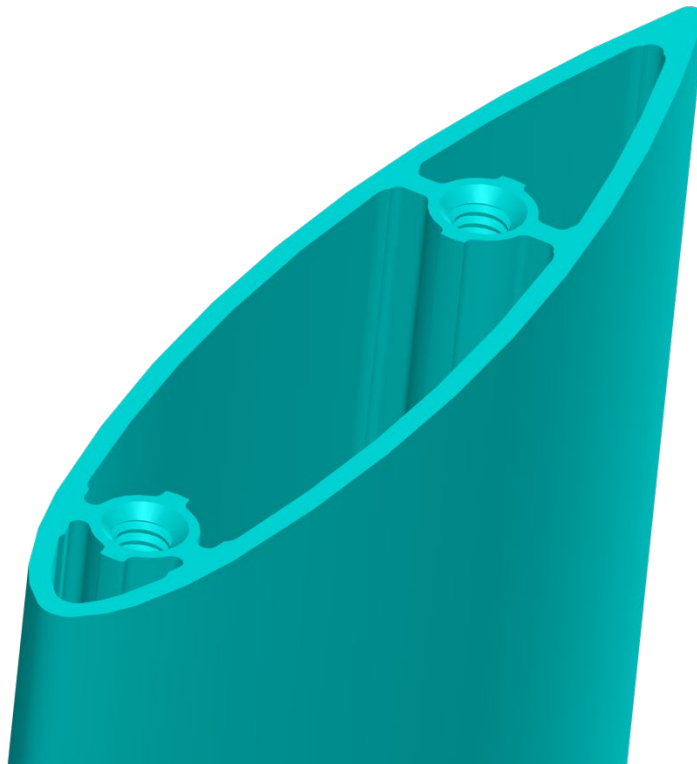

## 2. FIT FRONT FOIL

### TOOLS REQUIRED

ID	Description	Task
	4 mm Hex Drive / Allen Key	Fasten Front Foil M6 Countersunk Screws

2.1 Fit the Front Foil Shoe, with rounded end facing forward, onto the Front Tiller Strut.

[Tools: By hand only]



2.2 Position the Front Foil with leading edge (rounded edge) facing forward and holes aligning with that of the Front Foil

Shoe.

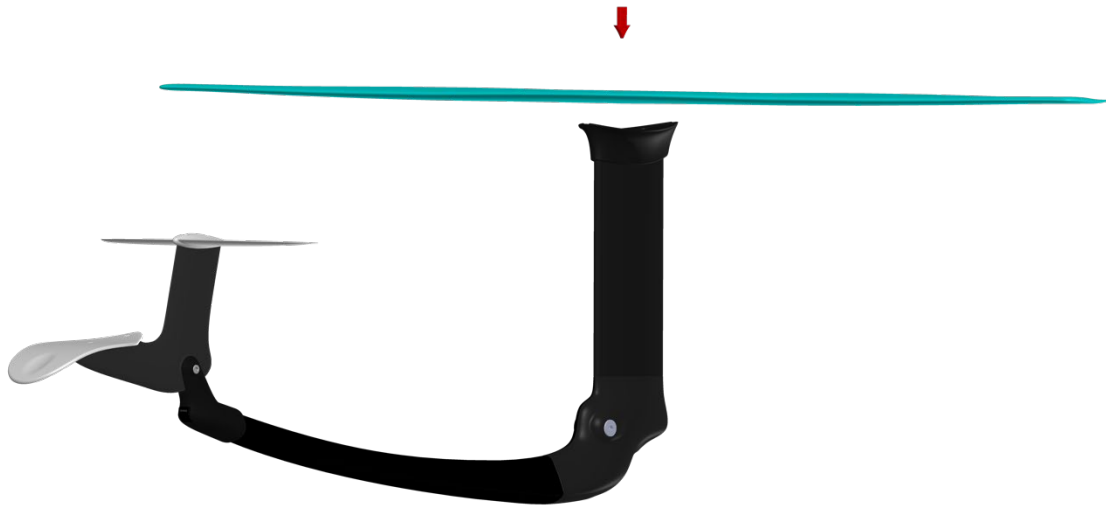

2.3 While holding the Front Tiller Assembly and Front Foil in position, insert the new 35mm length countersunk stainless steel replacement screws into the holes aligning with the Front Foil Shoe and threads on the Front Tiller Strut (aluminum extrusion).

**INFORMATION:** If the screws do not already have medium strength threadlocker tape (Loctite) applied, Loctite 243 or equivalent can be applied to the thread of the screws to prevent it from vibrating loose and reduce any effects from galvanic corrosion.

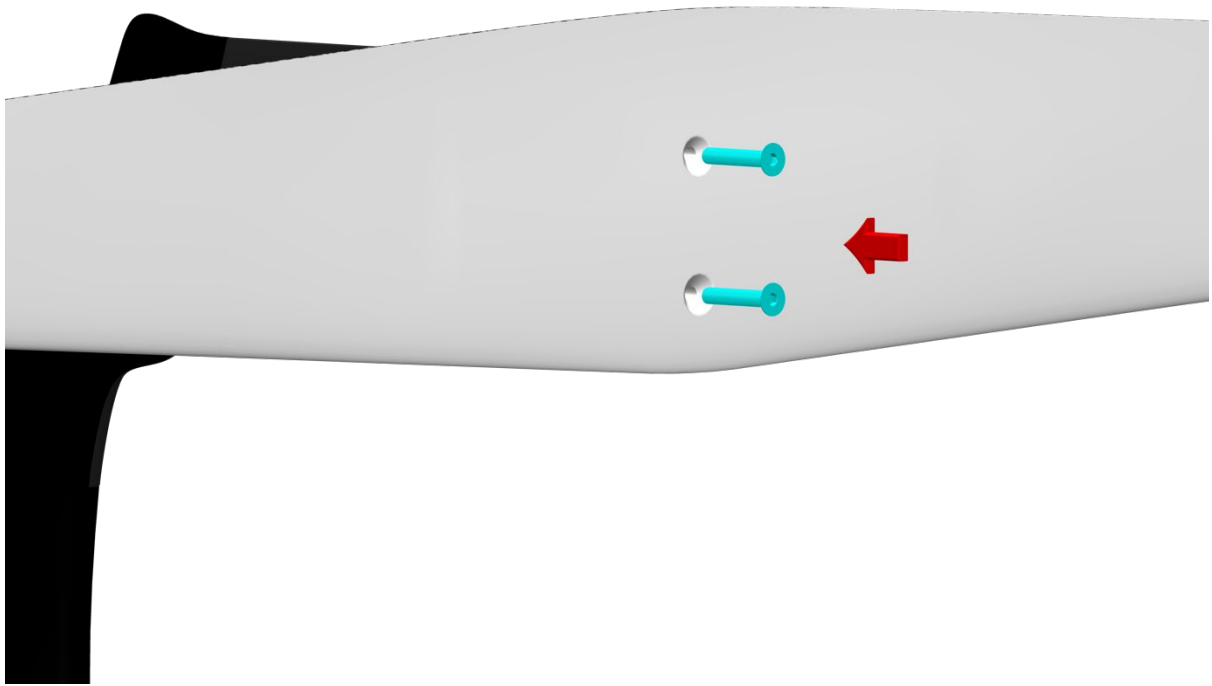

2.4 Fasten the two M6 countersunk stainless steel screws by rotating clockwise. [Tools: 4 mm Hex]

**INFORMATION:** If a torque wrench is used, fasten to 3 Nm.



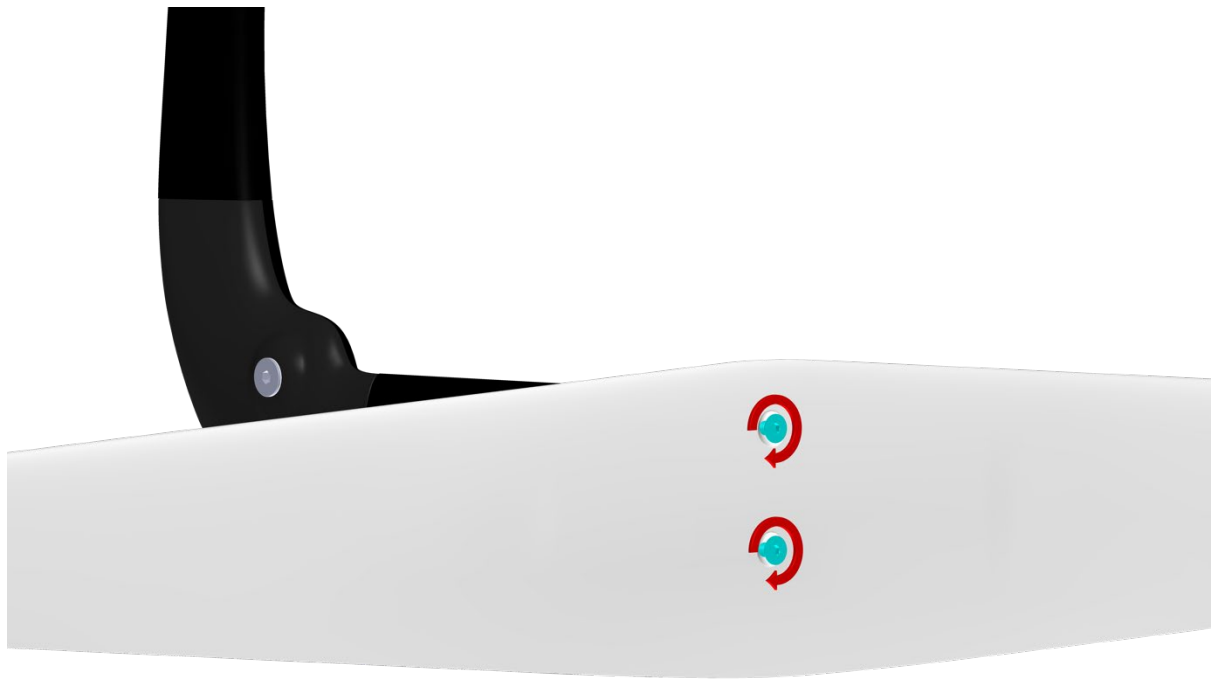

2.5 Completed Assembly.

**INFORMATION:** It is possible to fit the Front Foil Shoe and the Front Foil itself back to front, so take a moment to check the assembly.

