

This tutorial shows how to remove the Pedals from the XE-1

1. Work Instruction – Remove left hand (LH) and right hand (RH) Pedal

TOOLS REQUIRED

ID	Description	Task
	15 mm Pedal Wrench (Park Tool PW4 or PW5 is ideal)	Loosen Pedals

1.1 Remove the Left-Hand Pedal by rotating the pedal shaft clockwise.



INFORMATION: As with standard bicycle parts, the Left-Hand Pedal has a left-hand thread and the Right-Hand Bike Pedal has a right-hand thread. The pedals are fastened to 30 Nm when assembled in the factory and may require similar torque to loosen. It is strongly recommended that a pedal wrench with a minimum of lever length of 200 mm is used.

1.2 Remove the Right-Hand Pedal by rotating the pedal shaft anti-clockwise.

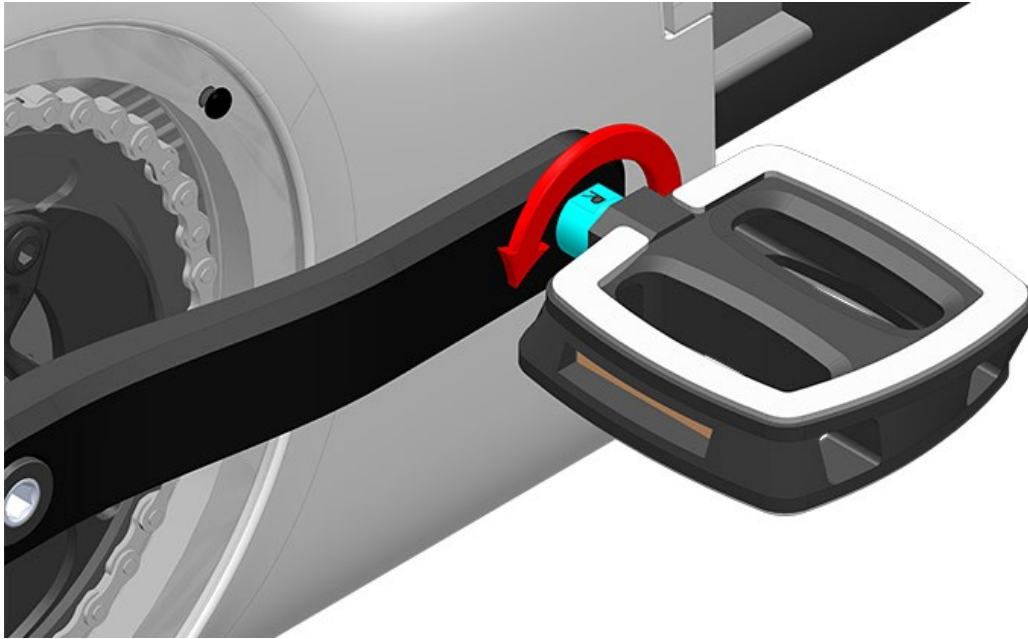

INFORMATION: The Right-Hand Pedal and Right-Hand Crank Arm have matching right-hand threads. If the Crank Arm does not accept the Right-Hand Pedal, check the markings on Pedal Shaft and Crank Arm.