

This tutorial shows how to remove the mini tiller from the front tiller assembly of the XE-1.

TOOLS REQUIRED

| ID | Description | Task |
|----|-------------|-------------------------------------|
| | M4 Hex Key | M5 Cap Screw – Mini Tiller to Pivot |

1. Work Instruction - Remove Mini Tiller Assembly

1.1 Loosen and remove the M5 stainless steel cap screw with a M4 Hex Key.

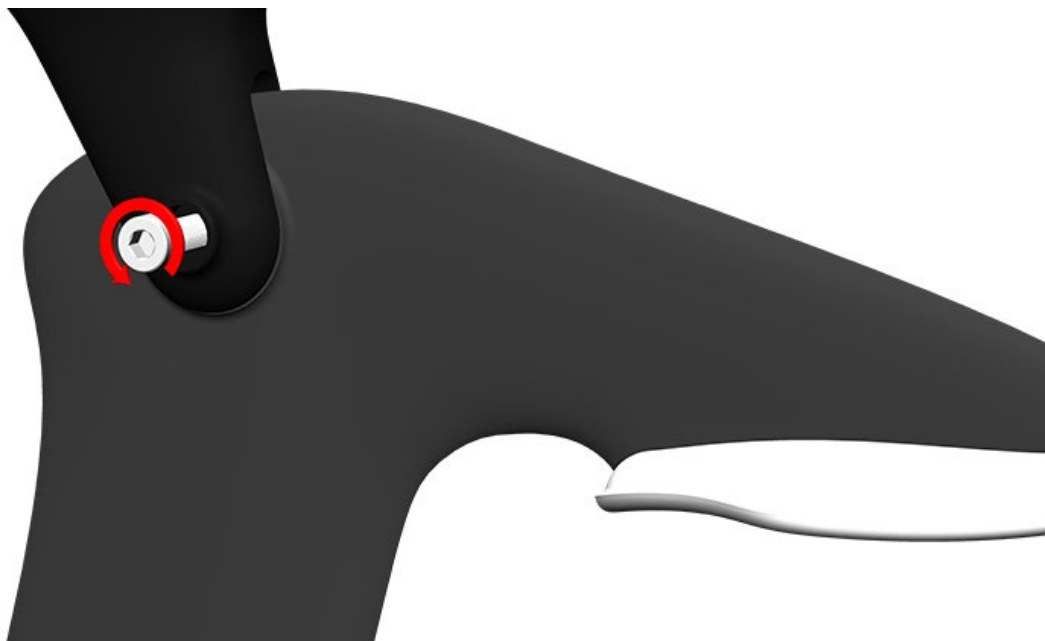

1.2 Remove the Mini Tiller Assembly.

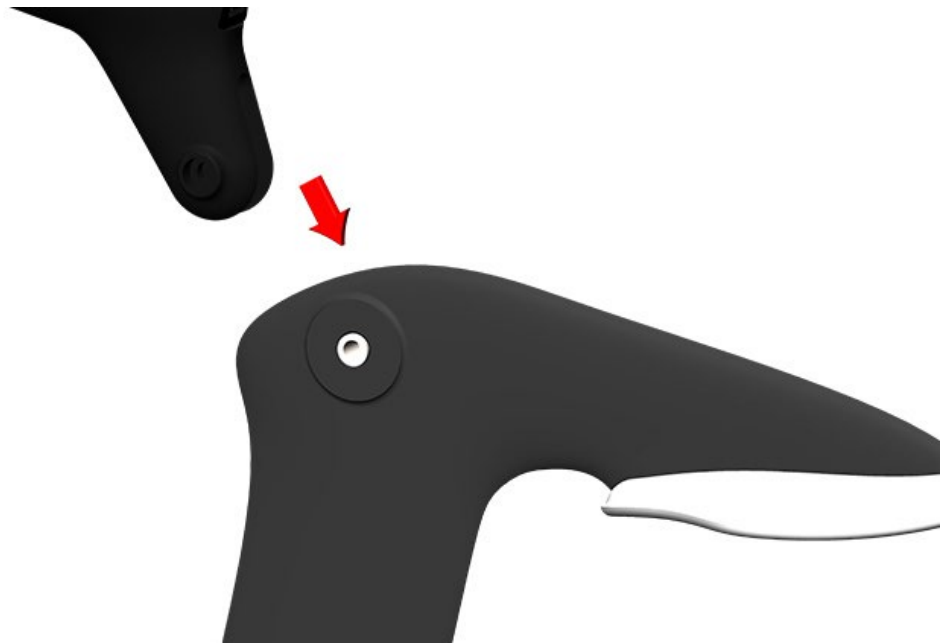

1.3 The M5 Nylock nut retained in the Front Tiller Pivot can remain in the Front Tiller Pivot if the Mini Tiller is replaced.



1.4 Remove the Mini Tiller Bush so that it can be re-used in the replacement Mini Tiller Assembly.

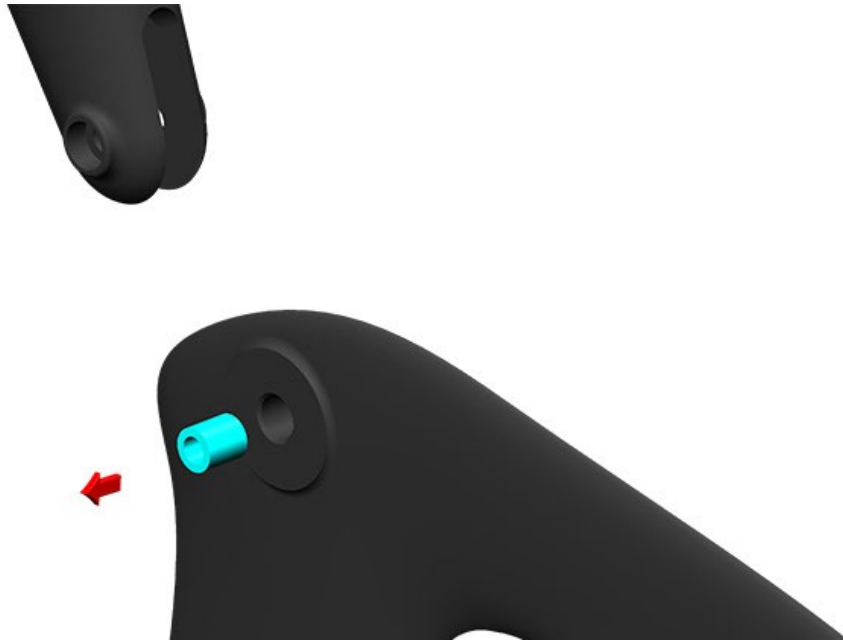

CAUTION: Secure the M5 nut during removal of the Mini Tiller Assembly to ensure that it is not lost.