

## FIT REAR BUOYANCY (Crank's Pre-removed)

This tutorial shows how to fit the Rear Buoyancy Module into the XE-1.

### 1. Work Instruction – Fit Rear Buoyancy

1.1 Position and hold Left-Hand Rear Buoyancy Module.

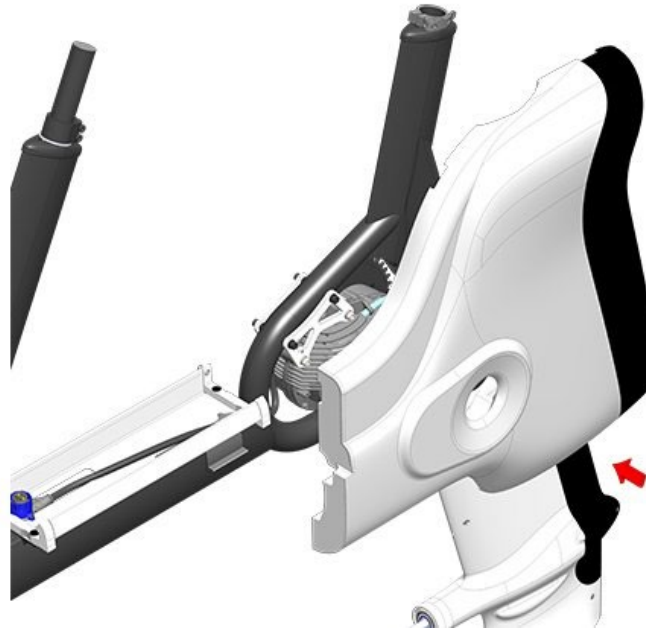

1.2 Position and hold Right-Hand Rear Buoyancy Module.



**INFORMATION:** As soon as the two Rear Buoyancy halves are in position, insert one of the Buoyancy Clips (white clip in front of the Seat Tube is a good option) so that the assembly is self-supported.

1.3 Insert all seven Buoyancy Clips (4 short white, 1 short black, 2 long black) to complete the assembly.

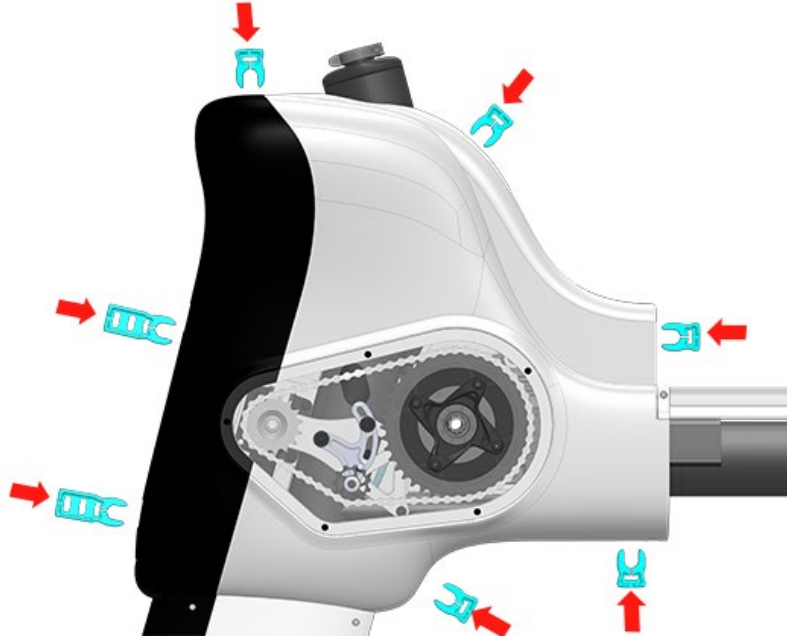

**INFORMATION:** Corresponding with the black and white colours of the Rear Buoyancy, four short white clips are fitted around the front, two long black clips at the rear and one short black clip is fitted on top behind the Seat Tube Clamp.