

FIT PROPELLER DRIVE SHAFT

This tutorial shows how to fit the Propeller Drive Shaft into the XE-1.

1. Fit Propeller Drive Shaft

Pre-Requisite: Remove Propeller Drive Shaft Assembly

TOOLS REQUIRED

ID	Description	Task
	17mm Open Wrench	Fasten M10 Nylock Nut

1.1 Information Only - Propeller Drive Shaft Assembly Images:

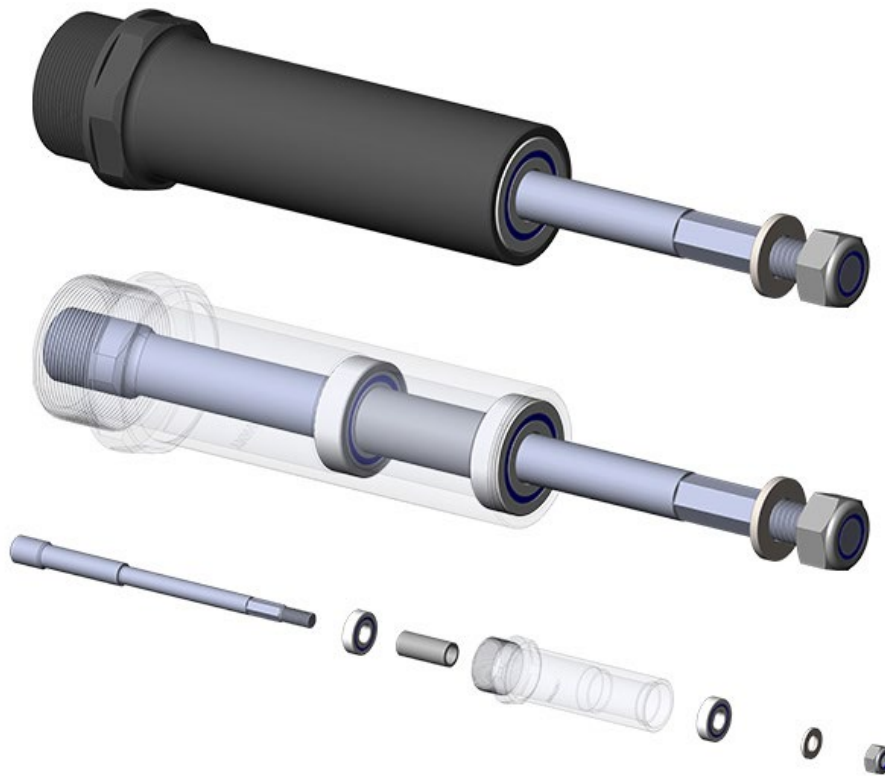

INFORMATION:

BEARING SPECIFICATION:

Description: S6001-2RS - BALL BEARING, RADIAL, SINGLE ROW SEALED

Material: STAINLESS STEEL 316.

1.2 Fit the M10 Stainless Steel Washer and Nylock Nut. Fasten the nut (rotate clockwise) until the nylon seal on the end of the nut engages with the thread. [Tools: By Hand Only]

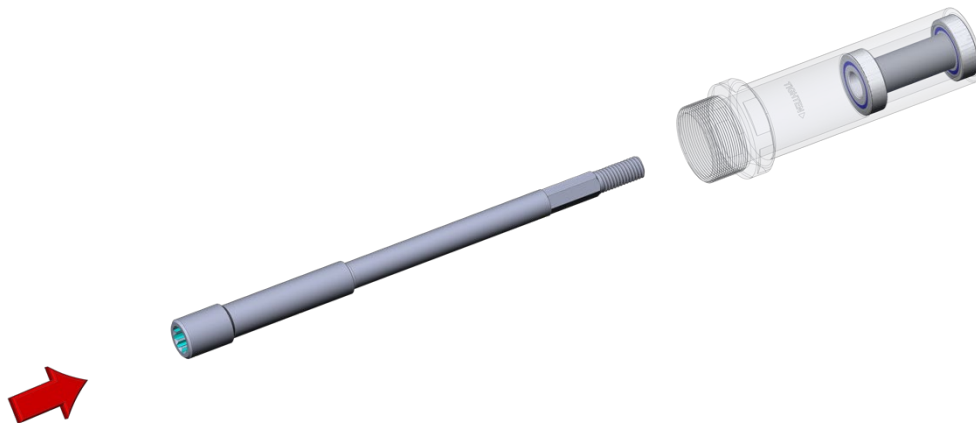

INFORMATION: Fitting the nut and washer at this stage ensures that the Propeller Drive Shaft does not drop out of the assembly and improves general safety by creating a blunt end for the drive shaft.

1.3 Fit the M10 Stainless Steel Washer and Nylock Nut. Fasten the nut (rotate clockwise) until the nylon seal on the end of the nut engages with the thread. [Tools: By Hand Only]

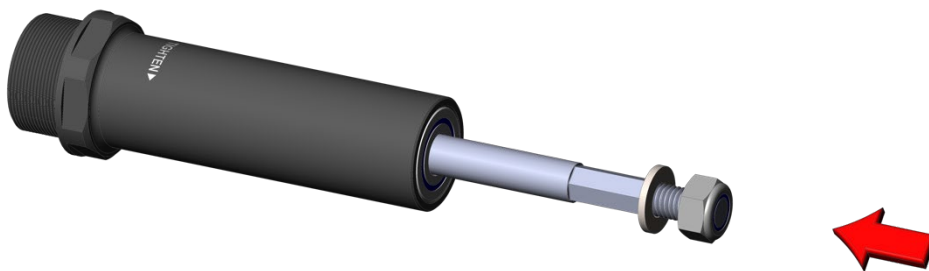

INFORMATION: Do not be concerned if the aft bearing inside the Propeller Drive Shaft Hub becomes dislodged and floats on the Propeller Drive Shaft. It locates on an internal shoulder, and will self-locate correctly as the Propeller Drive Shaft Assembly is aligned with the Bottom Gearbox Output Shaft and fastened to the XE-1 Frame.